

# 5TH GRADE

## *Area, Perimeter, & Volume*

# TASK CARDS



# THANK YOU FOR YOUR PURCHASE



DEAR TEACHER,

THIS RESOURCE IS FOR YOUR PERSONAL CLASSROOM USE IN ONE CLASSROOM ONLY. IF YOU WOULD LIKE ADDITIONAL COPIES FOR YOUR TEAMMATES, YOU CAN PURCHASE ADDITIONAL LICENSES FOR A DISCOUNT. TO PURCHASE ADDITIONAL LICENSES, GO TO YOUR "MY PURCHASES" PAGE ON TPT AND SELECT THE NUMBER OF LICENSES YOU WISH TO PURCHASE.



PLEASE VISIT MY  
**TEACHERS PAY TEACHERS** STORE:  
TEACHING IN THE *Fast Lane*  
FOR MANY DIFFERENT PRODUCTS!

[BITLY.COM/SHOPTEACHINGINTHEFASTLANE](https://bitly.com/shopTeachingInTheFastLane)  
[WWW.TEACHINGINTHEFASTLANE.COM](http://WWW.TEACHINGINTHEFASTLANE.COM)

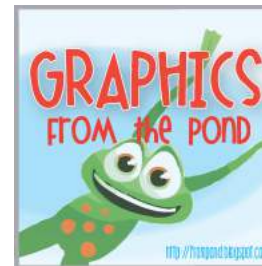

*Credits:*



Cover photo from Deposit Photos

TERMS OF USE: © 2017 TeachingInTheFastLaneLLC. ALL RIGHTS RESERVED. PURCHASE OF THIS PRODUCT ENTITLES THE PURCHASER THE RIGHT TO REPRODUCE THE PAGES FOR ONE CLASSROOM ONLY. DUPLICATION FOR MORE THAN ONE CLASSROOM SUCH AS ANOTHER TEACHER, GRADE LEVEL, SCHOOL, OR DISTRICT IS STRICTLY FORBIDDEN WITHOUT WRITTEN PERMISSION FROM THE AUTHOR. COPYING ANY PART OF THIS PRODUCT AND PLACING IT ON THE INTERNET IN ANY FORM IS STRICTLY FORBIDDEN AND IS A VIOLATION OF THE DIGITAL MILLENNIUM COPYRIGHT ACT (DMCA).



# MATH TASK CARDS

Included in this product are:

- 24 task cards with questions based on the 5<sup>th</sup> grade math TEKS
- Recording sheet for students to record their answers
- Answer key so that you or the students can check their work

Some ideas for using these cards are:

- Test prep and review
- As a center
- Partner work
- Small group review or activity
- Independent work
- Scavenger hunt

(My personal favorite-hang the cards in random order all around the room. Students hunt for each card and record their answers.)

- Play a whole class game such as Scoot
- Play Quiz-Quiz-Trade

# MATH TASK CARDS

Teacher Instructions:

1. Print product on cardstock for durability
2. Laminate and cut apart individual task cards
3. Copy enough answer sheets for each student to have one.
4. Store in a folder, envelope, sealing bag, or hole punch each card and place them on a ring.

1

A rectangular canvas is framed in wood. The canvas is 6.42 feet long and 4.87 feet tall. How many feet of wood framing are there?

2

A dog groomer's location is split into 3 rectangular areas. The tub is 4 feet long and 2.8 feet wide. The grooming area is 4 feet long and 6.5 feet wide. The waiting area is the combined size of the tub and grooming area. What is the area of the whole groomer's location?

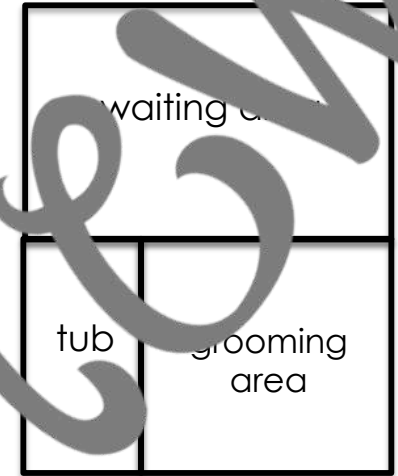

3

Anna bought a new refrigerator. It was delivered in a rectangular prism box that was 2.1 yards tall and had a 1 square yard base. What is the volume of the box?

4

A rectangular prism lunch box has a volume of 176 cubic inches. The area of one side of the lunch box is 38 square inches. What is the depth of the lunch box?

5

Sam delivers two television boxes to one house. The first box is 120 inches long, 90 inches tall, and 9 inches deep. The second box has a volume twice that of the first box. What is the volume of the second television box?

6

A shoe box is 12 inches long, 8 inches wide, and 4 inches deep. What is the area of the lid of the shoe box?

7

A classroom is split into three rectangular sections. The carpet area is 12.4 feet long and 10.5 feet wide. The small group area is a square with sides 8.6 feet long. What is the combined area of the carpet area and the library?

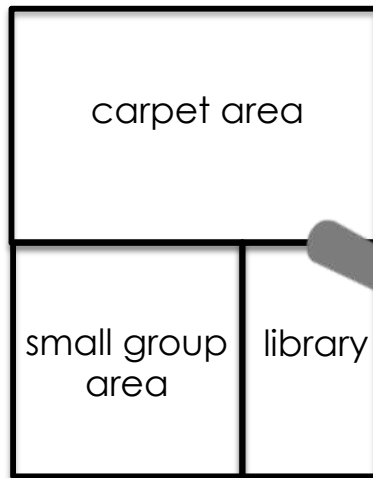

8

A rectangular hall runner has fringe all the way around. The rug is 2.6 feet wide and 18.4 feet long. Write an equation to find the amount of floor the hall runner covers up.

9

A restaurant sign is a rectangular prism. One face of the sign is 16 square feet. What is the depth of the sign if the volume is 48 cubic feet?

10

A dance studio is composed of three rectangular sections. Studio 1 is 30 feet long and 22 feet wide. Studio 2 and the lounge are both exactly half the length of studio 1 and the same width. What is the perimeter of the lounge?

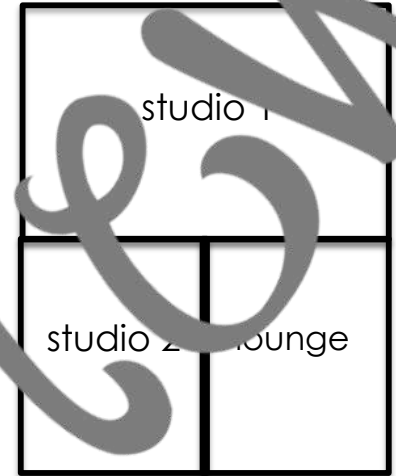

11

A square box has a side length of 12 inches. What is the volume of the box?

12

A square has a perimeter of 18 centimeters. What is the area of the square?

# 13

A rectangular shape of a playground has a perimeter of 104 feet. The length of one side is 30 feet. What is the width of the playground?

# 14

Rachel is placing ribbon around the lids of 3 identical square boxes. If the box is 17 inches wide, how much ribbon will she need?

# 15

The common area of a house is split into three rectangular areas. The kitchen is 2 meters long and 2.8 meters wide. The dining room is 2.7 meters long and 1.7 meters wide. What is the perimeter of the living room?

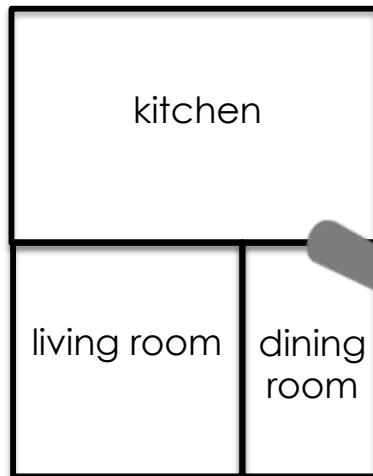

# 16

The base of a rectangular prism is 8 inches by 14 inches. The depth of the prism is 5 inches. What is the volume of the prism?



# 17

A food container is shaped as a rectangular prism. The volume of the container is 225 cubic inches. If the container is 5 inches deep and 9 inches wide, what is the width of the container?

# 18

A coffee shop is split into three rectangular areas. The service counter is 15 feet wide and 25 feet long. The Tables area is a square. If the sofas and chairs area is 17 feet wide, what is its area?

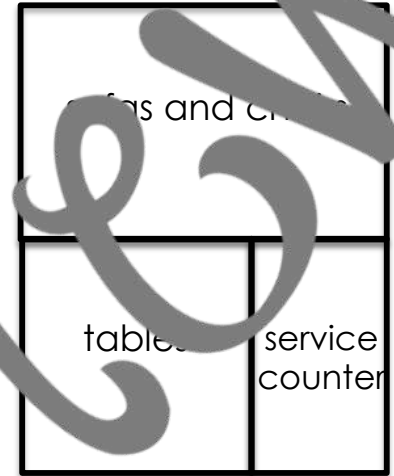

# 19

A book cover is 12 inches tall and 9 inches wide. The spine of the book is 2 inches wide. When standing up on a book shelf, how much space on the shelf will the book take up?

# 20

Joseph is looking for the amount of water it takes to fill a swimming pool. The pool is 20 yards long, 10 yards wide, and 6 feet deep. What is the volume of the pool?

# 21

A square shaped sandbox has a volume of 72 cubic feet. If the length of one side of the sandbox is 6 feet, what is the depth of the sandbox?

# 22

A rectangular box has a length of 24 inches, a width of 18 inches, and a depth of 16 inches. Write the formula you would use to find the volume of the box.

# 23

A bake sale table is split into three rectangular sections. The cookie section is 6 inches long and 12 inches wide. The brownies section is 11 inches long and 12 inches wide. What is the total area of the bake sale table?

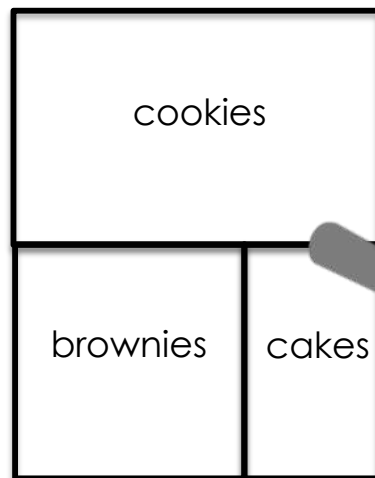

# 24

A rectangular painting is 5.1 feet tall and 3.9 feet wide. How much wall space will the painting take up?

Name \_\_\_\_\_

# \_\_\_\_\_

Date \_\_\_\_\_

# Area, Perimeter and Volume Task Cards

1	2	3	4	5	6
7	8	9	10	11	12
13	14	15	16	17	18
19	20	21	22	23	24

# Answer Key

## Area, Perimeter, & Volume Task Cards

1 22.58 feet of wood	2 74.4 square feet	3 1.1 cubic yards	4 2 inches	5 194,400 cubic inches	6 16 square inches
7 166.6 square feet	8 $52.4 \times 2.6 =$ area	9 3 feet	10 74 feet	11 5,728 cubic inches	12 729 square centimeters
13 22.5	14 204 inches of ribbon	15 10.8 meters	16 560 cubic inches	17 5 inches	18 680 square feet
19 15 square inches	20 400 cubic yards	21 2 feet	22 $24 \times 18 \times 16 =$ volume	23 384 square inches	24 21.06 square feet